

# Oracle® MiniCluster S7-2 Service Manual

ORACLE®

Part No: E76798-05  
April 2021



**Part No: E76798-05**

Copyright © 2016, 2021, Oracle and/or its affiliates.

This software and related documentation are provided under a license agreement containing restrictions on use and disclosure and are protected by intellectual property laws. Except as expressly permitted in your license agreement or allowed by law, you may not use, copy, reproduce, translate, broadcast, modify, license, transmit, distribute, exhibit, perform, publish, or display any part, in any form, or by any means. Reverse engineering, disassembly, or decompilation of this software, unless required by law for interoperability, is prohibited.

The information contained herein is subject to change without notice and is not warranted to be error-free. If you find any errors, please report them to us in writing.

If this is software or related documentation that is delivered to the U.S. Government or anyone licensing it on behalf of the U.S. Government, then the following notice is applicable:

U.S. GOVERNMENT END USERS: Oracle programs (including any operating system, integrated software, any programs embedded, installed or activated on delivered hardware, and modifications of such programs) and Oracle computer documentation or other Oracle data delivered to or accessed by U.S. Government end users are "commercial computer software" or "commercial computer software documentation" pursuant to the applicable Federal Acquisition Regulation and agency-specific supplemental regulations. As such, the use, reproduction, duplication, release, display, disclosure, modification, preparation of derivative works, and/or adaptation of i) Oracle programs (including any operating system, integrated software, any programs embedded, installed or activated on delivered hardware, and modifications of such programs), ii) Oracle computer documentation and/or iii) other Oracle data, is subject to the rights and limitations specified in the license contained in the applicable contract. The terms governing the U.S. Government's use of Oracle cloud services are defined by the applicable contract for such services. No other rights are granted to the U.S. Government.

This software or hardware is developed for general use in a variety of information management applications. It is not developed or intended for use in any inherently dangerous applications, including applications that may create a risk of personal injury. If you use this software or hardware in dangerous applications, then you shall be responsible to take all appropriate fail-safe, backup, redundancy, and other measures to ensure its safe use. Oracle Corporation and its affiliates disclaim any liability for any damages caused by use of this software or hardware in dangerous applications.

Oracle and Java are registered trademarks of Oracle and/or its affiliates. Other names may be trademarks of their respective owners.

Intel and Intel Inside are trademarks or registered trademarks of Intel Corporation. All SPARC trademarks are used under license and are trademarks or registered trademarks of SPARC International, Inc. AMD, Epyc, and the AMD logo are trademarks or registered trademarks of Advanced Micro Devices. UNIX is a registered trademark of The Open Group.

This software or hardware and documentation may provide access to or information about content, products, and services from third parties. Oracle Corporation and its affiliates are not responsible for and expressly disclaim all warranties of any kind with respect to third-party content, products, and services unless otherwise set forth in an applicable agreement between you and Oracle. Oracle Corporation and its affiliates will not be responsible for any loss, costs, or damages incurred due to your access to or use of third-party content, products, or services, except as set forth in an applicable agreement between you and Oracle.

**Documentation Accessibility**

For information about Oracle's commitment to accessibility, visit the Oracle Accessibility Program website at <http://www.oracle.com/pls/topic/lookup?ctx=acc&id=docacc>.

**Access to Oracle Support**

Oracle customers that have purchased support have access to electronic support through My Oracle Support. For information, visit <http://www.oracle.com/pls/topic/lookup?ctx=acc&id=info> or visit <http://www.oracle.com/pls/topic/lookup?ctx=acc&id=trs> if you are hearing impaired.

**Diversity and Inclusion**

Oracle is fully committed to diversity and inclusion. Oracle recognizes the influence of ethnic and cultural values and is working to remove language from our products and documentation that might be considered insensitive. While doing so, we are also mindful of the necessity to maintain compatibility with our customers' existing technologies and the need to ensure continuity of service as Oracle's offerings and industry standards evolve. Because of these technical constraints, our effort to remove insensitive terms is an ongoing, long-term process.

**Référence: E76798-05**

Copyright © 2016, 2021, Oracle et/ou ses affiliés.

Ce logiciel et la documentation qui l'accompagne sont protégés par les lois sur la propriété intellectuelle. Ils sont concédés sous licence et soumis à des restrictions d'utilisation et de divulgation. Sauf stipulation expresse de votre contrat de licence ou de la loi, vous ne pouvez pas copier, reproduire, traduire, diffuser, modifier, accorder de licence, transmettre, distribuer, exposer, exécuter, publier ou afficher le logiciel, même partiellement, sous quelque forme et par quelque procédé que ce soit. Par ailleurs, il est interdit de procéder à toute ingénierie inverse du logiciel, de le désassembler ou de le décompiler, excepté à des fins d'interopérabilité avec des logiciels tiers ou tel que prescrit par la loi.

Les informations fournies dans ce document sont susceptibles de modification sans préavis. Par ailleurs, Oracle Corporation ne garantit pas qu'elles soient exemptes d'erreurs et vous invite, le cas échéant, à lui en faire part par écrit.

Si ce logiciel, ou la documentation qui l'accompagne, est livré sous licence au Gouvernement des Etats-Unis, ou à quiconque qui aurait souscrit la licence de ce logiciel pour le compte du Gouvernement des Etats-Unis, la notice suivante s'applique :

U.S. GOVERNMENT END USERS: Oracle programs (including any operating system, integrated software, any programs embedded, installed or activated on delivered hardware, and modifications of such programs) and Oracle computer documentation or other Oracle data delivered to or accessed by U.S. Government end users are "commercial computer software" or "commercial computer software documentation" pursuant to the applicable Federal Acquisition Regulation and agency-specific supplemental regulations. As such, the use, reproduction, duplication, release, display, disclosure, modification, preparation of derivative works, and/or adaptation of i) Oracle programs (including any operating system, integrated software, any programs embedded, installed or activated on delivered hardware, and modifications of such programs), ii) Oracle computer documentation and/or iii) other Oracle data, is subject to the rights and limitations specified in the license contained in the applicable contract. The terms governing the U.S. Government's use of Oracle cloud services are defined by the applicable contract for such services. No other rights are granted to the U.S. Government.

Ce logiciel ou matériel a été développé pour un usage général dans le cadre d'applications de gestion des informations. Ce logiciel ou matériel n'est pas conçu ni n'est destiné à être utilisé dans des applications à risque, notamment dans des applications pouvant causer un risque de dommages corporels. Si vous utilisez ce logiciel ou matériel dans le cadre d'applications dangereuses, il est de votre responsabilité de prendre toutes les mesures de secours, de sauvegarde, de redondance et autres mesures nécessaires à son utilisation dans des conditions optimales de sécurité. Oracle Corporation et ses affiliés déclinent toute responsabilité quant aux dommages causés par l'utilisation de ce logiciel ou matériel pour des applications dangereuses.

Oracle et Java sont des marques déposées d'Oracle Corporation et/ou de ses affiliés. Tout autre nom mentionné peut correspondre à des marques appartenant à d'autres propriétaires qu'Oracle.

Intel et Intel Inside sont des marques ou des marques déposées d'Intel Corporation. Toutes les marques SPARC sont utilisées sous licence et sont des marques ou des marques déposées de SPARC International, Inc. AMD, Epyc, et le logo AMD sont des marques ou des marques déposées d'Advanced Micro Devices. UNIX est une marque déposée de The Open Group.

Ce logiciel ou matériel et la documentation qui l'accompagne peuvent fournir des informations ou des liens donnant accès à des contenus, des produits et des services émanant de tiers. Oracle Corporation et ses affiliés déclinent toute responsabilité ou garantie expresse quant aux contenus, produits ou services émanant de tiers, sauf mention contraire stipulée dans un contrat entre vous et Oracle. En aucun cas, Oracle Corporation et ses affiliés ne sauraient être tenus pour responsables des pertes subies, des coûts occasionnés ou des dommages causés par l'accès à des contenus, produits ou services tiers, ou à leur utilisation, sauf mention contraire stipulée dans un contrat entre vous et Oracle.

**Accessibilité de la documentation**

Pour plus d'informations sur l'engagement d'Oracle pour l'accessibilité de la documentation, visitez le site Web Oracle Accessibility Program, à l'adresse : <http://www.oracle.com/pls/topic/lookup?ctx=acc&id=docacc>.

**Accès aux services de support Oracle**

Les clients Oracle qui ont souscrit un contrat de support ont accès au support électronique via My Oracle Support. Pour plus d'informations, visitez le site <http://www.oracle.com/pls/topic/lookup?ctx=acc&id=info> ou le site <http://www.oracle.com/pls/topic/lookup?ctx=acc&id=trs> si vous êtes malentendant.

# Contents

---

- Using This Documentation** ..... 7
  - Product Documentation Library ..... 7
  - Feedback ..... 7
  
- Overview of System Status Indicators and LEDs** ..... 9
  - Compute Node Status Indicators ..... 9
  - Storage Array Front Panel and Drive Indicators ..... 9
  - Storage Array Back Panel Indicators ..... 11
  
- Preparing MiniCluster for Service** ..... 13
  - Component Service Categories ..... 13
  - Detecting and Managing Faults ..... 14
  - Preparing MiniCluster For Service ..... 15
  
- Servicing CRUs That Do Not Require System Power Off** ..... 17
  - Compute Node Hot-Swappable Components ..... 17
  - Storage Array Hot-Swappable Components ..... 18
    - Replacement Procedures ..... 18
  
- Servicing CRUs That Require Compute Node Power Off** ..... 31
  - Servicing Compute Node CRUs ..... 31
  
- Servicing FRUs** ..... 33
  - Servicing Compute Node FRUs ..... 33
  
- Returning MiniCluster to Operation** ..... 35
  - Returning the System to Operation ..... 35

▼ Power On Procedure .....	35
<b>Index</b> .....	<b>37</b>

## Using This Documentation

---

- **Overview** – Describes how to service Oracle's MiniCluster S7-2 hardware
- **Audience** – System administrators and authorized service providers
- **Required knowledge** – Advanced experience installing enterprise servers

## Product Documentation Library

Documentation and resources for this product and related products are available at <https://docs.oracle.com/en/engineered-systems/minicluster-s7-2/>.

## Feedback

Provide feedback about this documentation at <http://www.oracle.com/goto/docfeedback>.





# Overview of System Status Indicators and LEDs

---

This chapter describes system status indicators and LEDs.

- [“Compute Node Status Indicators” on page 9](#)
- [“Storage Array Front Panel and Drive Indicators” on page 9](#)
- [“Storage Array Back Panel Indicators” on page 11](#)

## Compute Node Status Indicators

These topics describe MiniCluster compute node status indicators (LEDs).

---

**Note** - The links below take you to topics *outside* of the MiniCluster library to the Oracle SPARC S7-2 documentation library. Use your browser's Back button to return to the MiniCluster library.

---

- [“Front Panel Components” in \*SPARC S7-2 Server Service Manual\*](#)
- [“Rear Panel Components” in \*SPARC S7-2 Server Service Manual\*](#)

## Storage Array Front Panel and Drive Indicators

The following figure shows the controls and indicators on the storage array front panel and drives.

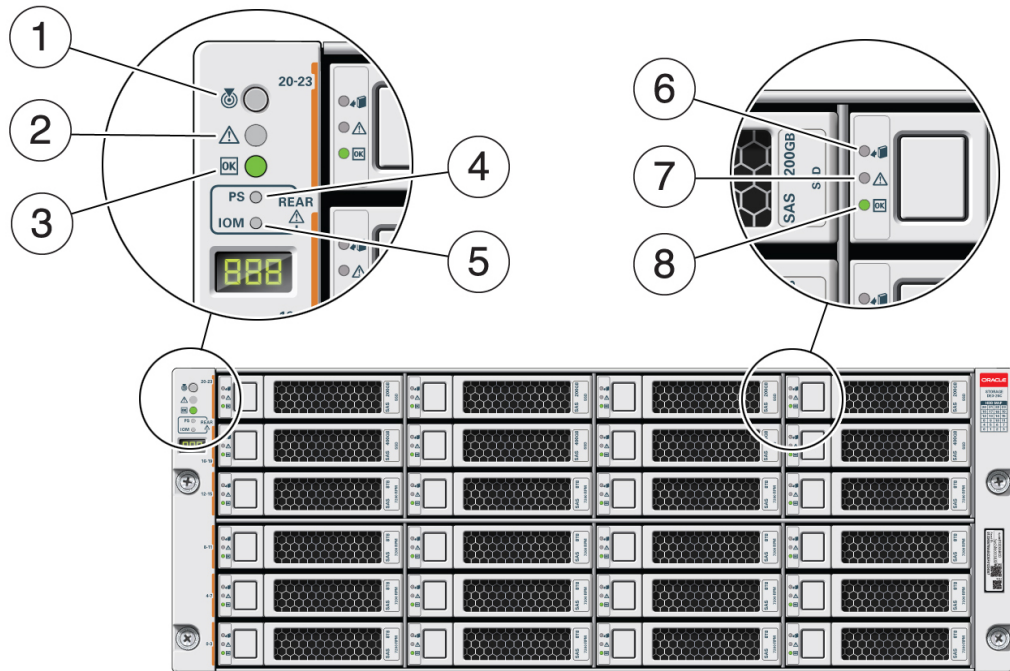

Callout	Indicator/LED: Color	State Meaning
1	Locate: white	<ul style="list-style-type: none"> <li>■ Off – Normal operation.</li> <li>■ Fast blink – This LED blinks to help locate the system. Operators can turn this indicator on and off remotely using Oracle ILOM.</li> <li>■ Pressing this button toggles the fast blink on or off.</li> </ul>
2	Service Required: amber	<ul style="list-style-type: none"> <li>■ Off – Normal operation.</li> <li>■ Steady on – A fault is present in the storage array.</li> </ul>
3	OK: green	<ul style="list-style-type: none"> <li>■ On – The storage array is powered on and operating normally.</li> <li>■ Off – The storage array is unplugged or turned off.</li> </ul>
4	Power Supply fault indicator: amber	<ul style="list-style-type: none"> <li>■ On – Indicates a fault with a power supply. View the LEDs at the back of the storage array to determine which power supply has the fault.</li> <li>■ Off – Normal operation.</li> </ul>
5	SAS I/O Module fault indicator: amber	Service Required – Lights amber to indicate a fault with an I/O module. View the LEDs at the back of the storage array to determine which module has the fault.
6	Ready-to-Remove: blue	<ul style="list-style-type: none"> <li>■ On – The storage drive can be safely removed during a hot-plug operation.</li> <li>■ Off – The storage drive has not been prepared for removal.</li> </ul>
7	Drive Service Required: amber	<ul style="list-style-type: none"> <li>■ Off – Normal operation.</li> </ul>

Callout	Indicator/LED: Color	State Meaning
8	Power/Activity: green	<ul style="list-style-type: none"> <li>■ Steady on – A fault is present in the disk drive.</li> <li>■ On – The drive is installed and recognized by the system but there is no drive activity.</li> <li>■ Blink – The LED blinks randomly in response to data being written to or read from the drive.</li> <li>■ Off – The drive is powered off or the installed drive is not recognized by the system.</li> </ul>

## Storage Array Back Panel Indicators

The following figure shows the controls and indicators on the storage array back panel and drives.

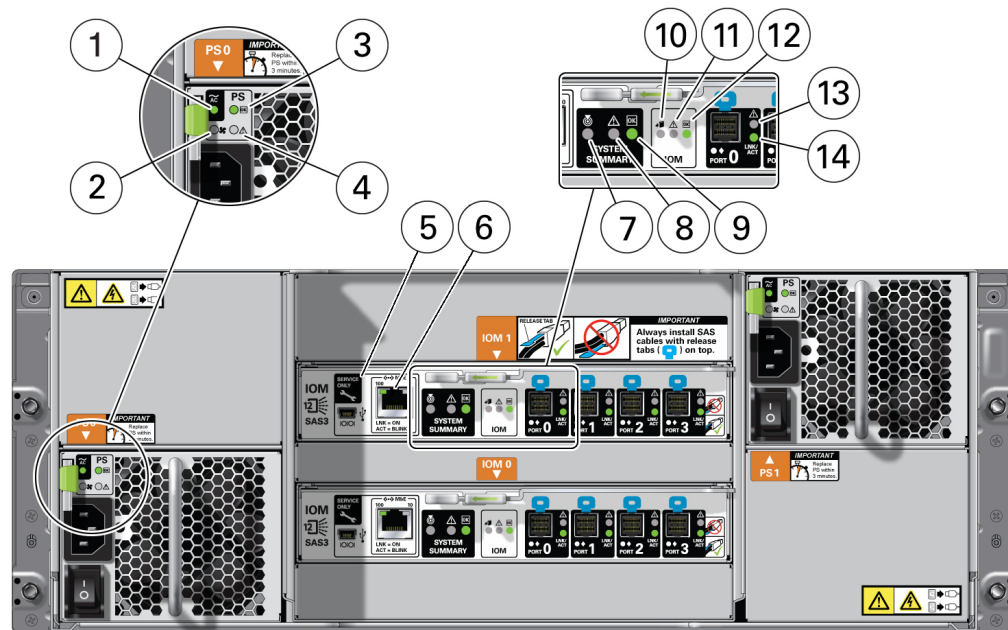

Callout	Indicator/LED: Color	State Meaning
1	AC power fault indicator: amber	<ul style="list-style-type: none"> <li>■ On – Indicates an AC power fault.</li> <li>■ Off – Normal operation.</li> </ul>

Callout	Indicator/LED: Color	State Meaning
2	Fan fail indicator: amber	<ul style="list-style-type: none"> <li>■ On – The fan is faulty.</li> <li>■ Off – Normal operation.</li> </ul>
3	Power supply status indicator: green	<ul style="list-style-type: none"> <li>■ On – The power supply is operating normally.</li> <li>■ Off – The power supply is unplugged or turned off.</li> </ul>
4	DC power fail indicator: amber	<ul style="list-style-type: none"> <li>■ On – The power supply is faulty.</li> <li>■ Off – Normal operation.</li> </ul>
5	Reserved	This port is reserved for Oracle Service.
6	Network port (reserved)	This port is reserved for Oracle Service.
7	Locate: white	<ul style="list-style-type: none"> <li>■ Off – Normal operation.</li> <li>■ Fast blink – This LED blinks to help locate the system. Operators can turn this indicator on and off remotely using Oracle ILOM.</li> <li>■ Pressing this button toggles the fast blink on or off.</li> </ul>
8	Service Required: amber	<ul style="list-style-type: none"> <li>■ Off – Normal operation.</li> <li>■ Steady on – A fault is present in the storage array.</li> </ul>
9	OK: green	<ul style="list-style-type: none"> <li>■ On – The storage array is powered on and operating normally.</li> <li>■ Off – The storage array is unplugged or turned off.</li> </ul>
10	SAS I/O Module Ready-to-Remove: blue	<ul style="list-style-type: none"> <li>■ On – The I/O module can be safely removed during a hot-plug operation.</li> <li>■ Off – The I/O module has not been prepared for removal.</li> </ul>
11	SAS I/O Module fault indicator: amber	Service Required – Lights amber to indicate a fault with an I/O module.
12	SAS I/O Module OK: green	<ul style="list-style-type: none"> <li>■ On – The I/O module is powered on and operating normally.</li> <li>■ Off – The I/O module is unplugged or turned off.</li> </ul>
13	Host SAS port fault indicator: amber	Service Required – Lights amber to indicate a fault with the port or connection.
14	Host SAS port activity indicator: green	Lights green to indicate host SAS link activity.

# Preparing MiniCluster for Service

---

This chapter describes how to prepare MiniCluster for servicing.

- [“Component Service Categories” on page 13](#)
- [“Detecting and Managing Faults” on page 14](#)
- [“Preparing MiniCluster For Service” on page 15](#)

## Component Service Categories

The server components and assemblies that can be replaced in the field fall into three categories:

- Hot-service, replaceable by customer
- Cold-service, replaceable by customer
- Cold-service, replaceable by authorized service personnel

Cold service procedures require that you shut the server down and unplug the power cables that connect the power supplies to the power source.

Although hot service procedures can be performed while the server is running, you should usually bring it to standby mode as the first step in the replacement procedure. See [“Preparing MiniCluster For Service” on page 15](#) for instructions.

This table identifies the components in each category.

Component Service Category	Component	Service Information
Hot-service, replaceable by customer	Drives, compute node	<a href="#">“Servicing Drives” in SPARC S7-2 Server Service Manual</a>
	Fan modules, compute node	<a href="#">“Servicing Fan Modules” in SPARC S7-2 Server Service Manual</a>
	Power supplies, compute node	<a href="#">“Servicing Power Supplies” in SPARC S7-2 Server Service Manual</a>

Component Service Category	Component	Service Information
	HDD or SSD, storage array	<a href="#">“Replace a Storage Array HDD or SSD (CRU)” on page 18</a>
	Power supplies, storage array	<a href="#">“Replace a Storage Array Power Supply (CRU)” on page 24</a>
	I/O module, storage array	<a href="#">“Replace a Storage Array I/O Module (CRU)” on page 28</a>
Cold-service, replaceable by customer	DIMMs, compute node	<a href="#">“Servicing DIMMs” in <i>SPARC S7-2 Server Service Manual</i></a>
	Battery, compute node	<a href="#">“Servicing the Battery” in <i>SPARC S7-2 Server Service Manual</i></a>
	PCIe cards, compute node	<a href="#">“Servicing PCIe Cards” in <i>SPARC S7-2 Server Service Manual</i></a>
	Front indicator module, compute node	<a href="#">“Servicing the Front Indicator Module” in <i>SPARC S7-2 Server Service Manual</i></a>
	eUSB drive, compute node	<a href="#">“Servicing the eUSB Drive” in <i>SPARC S7-2 Server Service Manual</i></a>
Cold-service, replaceable by authorized service personnel	Cables, compute node	<a href="#">“Servicing Cables” in <i>SPARC S7-2 Server Service Manual</i></a>
	Drive backplane, compute node	<a href="#">“Servicing the Drive Backplane” in <i>SPARC S7-2 Server Service Manual</i></a>
	Motherboard, compute node	<a href="#">“Servicing the Motherboard” in <i>SPARC S7-2 Server Service Manual</i></a>

## Detecting and Managing Faults

---

**Note** - The links in this list take you to instructions that are in other documents. Open the links in a new tab or use your browser's Back button to return to this document.

---

- [“Checking for Faults” in \*SPARC S7-2 Server Service Manual\*](#)
- [“Log In to Oracle ILOM \(Service\)” in \*SPARC S7-2 Server Service Manual\*](#)
- [“Identify Faulted Components” in \*SPARC S7-2 Server Service Manual\*](#)
- [“Performing Advanced Troubleshooting” in \*SPARC S7-2 Server Service Manual\*](#)
- [“Check the Message Buffer” in \*SPARC S7-2 Server Service Manual\*](#)
- [“View Log Files \(Oracle Solaris\)” in \*SPARC S7-2 Server Service Manual\*](#)
- [“View Log Files \(Oracle ILOM\)” in \*SPARC S7-2 Server Service Manual\*](#)
- [“POST Overview” in \*SPARC S7-2 Server Service Manual\*](#)
- [“Configure POST” in \*SPARC S7-2 Server Service Manual\*](#)
- [“Oracle ILOM Properties That Affect POST Behavior” in \*SPARC S7-2 Server Service Manual\*](#)
- [“Clear a Fault Manually” in \*SPARC S7-2 Server Service Manual\*](#)

## Preparing MiniCluster For Service

Most service procedures are performed on a single appliance component. Service procedures that require a single compute node to be powered off can be performed without shutting down the entire MiniCluster.

**Note** - The links in this table take you to instructions that are in other documents. Open the links in a new tab or use your browser's Back button to return to this document.

Task	For More Information
<b>Review safety information.</b>	<a href="#">Safety Information</a> in the <i>SPARC S7-2 Server Service Manual</i>
<b>Gather required tools.</b>	<a href="#">Service Tools</a> in the <i>SPARC S7-2 Server Service Manual</i>
<b>Find the server serial number.</b>	<a href="#">Find the Server Serial Number</a> in the <i>SPARC S7-2 Server Service Manual</i>
<b>Locate the server in the data center.</b>	<a href="#">Locate the Server</a> in the <i>SPARC S7-2 Server Service Manual</i>
<b>Shut the compute nodes down gracefully.</b>	<a href="#">Shut Down, Reset, or Power Cycle the System</a> in the <i>MiniCluster S7-2 Administration Guide</i> .
<b>Power off the compute nodes.</b>  <i>Caution</i> – Shut both compute nodes down gracefully before powering off the server.	<a href="#">Power Off the Server</a> in the <i>SPARC S7-2 Server Service Manual</i>
<b>Power off the storage array.</b>  <i>Caution</i> – Power off both compute nodes before powering off the storage array.	<ol style="list-style-type: none"> <li>Place the storage array power supply on/off switches to the "0" off position. Note – There are two power supplies for each array. Power off all power supplies.</li> <li>Disconnect both power cords from the power source. Note – All power cords must be disconnected to completely remove power from the storage array.</li> </ol>
<b>Label cables then disconnect the cables.</b>	<a href="#">Disconnect Cables From the Server</a> in the <i>SPARC S7-2 Server Service Manual</i>
<b>Prevent ESD damage.</b>	<a href="#">Prevent ESD Damage</a> in the <i>SPARC S7-2 Server Service Manual</i>
<b>Extend the server to the service position.</b>	<a href="#">Extend the Server to the Service Position</a> in the <i>SPARC S7-2 Server Service Manual</i>
<b>Remove the server from the rack.</b>	<a href="#">Remove the Server From the Rack</a> in the <i>SPARC S7-2 Server Service Manual</i>
<b>Open the server fan door.</b>	<a href="#">Open the Server Fan Door</a> in the <i>SPARC S7-2 Server Service Manual</i>
<b>Remove the server top cover.</b>	<a href="#">Remove the Top Cover</a> in the <i>SPARC S7-2 Server Service Manual</i>





# Servicing CRUs That Do Not Require System Power Off

---

This chapter describes how to remove and replace the hot-swappable components in MiniCluster. Hot-swappable means that these components can be replaced with the system powered on.

---

**Note** - Hot-swappable components can also be replaced with the system powered off. If you choose this method, first power off the system as described in [“Preparing MiniCluster for Service” on page 13](#).

---

The following topics are covered:

- [“Compute Node Hot-Swappable Components” on page 17](#)
- [“Storage Array Hot-Swappable Components” on page 18](#)

## Compute Node Hot-Swappable Components

This section describes replacing hot-swappable components for the compute node.

Hot-swappable components are those that can be removed and installed while the system and the compute nodes are running without requiring any administrative tasks. These are designated as Customer Replaceable Units (CRUs).

Refer to the following table for hot-swap component instructions for your appliance.

---

**Note** - The links in the following table take you to instructions *outside* of the MiniCluster library to the SPARC S7-2 documentation library. Use your browser's Back button to return to the MiniCluster library.

---

- [“Servicing Drives” in \*SPARC S7-2 Server Service Manual\*](#)

- [“Servicing Fan Modules” in SPARC S7-2 Server Service Manual](#)
- [“Servicing Power Supplies” in SPARC S7-2 Server Service Manual](#)

## Storage Array Hot-Swappable Components

This section describes replacing hot-swappable components for the storage array.

Hot-swappable components are those that can be removed and installed while the system and the compute nodes are running without requiring any administrative tasks. These are designated as Customer Replaceable Units (CRUs).



---

**Caution - Data loss.** Do not remove power from both power supplies of the storage array or storage expansion shelf (if equipped) while the database is running. If you must power off the storage array or expansion storage array, stop the database first.

---

---

**Note -** After a physical insertion or removal action of a storage array component (such as a disk or SAS cable), you should wait before performing the next action to allow the system software to fully process the event. This could take up to 3 minutes to complete.

---

## Replacement Procedures

These storage array components can be replaced while the storage array is powered-on and running:

- [“Replace a Storage Array HDD or SSD \(CRU\)” on page 18](#)
- [“Replace a Storage Array Power Supply \(CRU\)” on page 24](#)
- [“Replace a Storage Array I/O Module \(CRU\)” on page 28](#)

### Replace a Storage Array HDD or SSD (CRU)

Use these procedures to replace a storage array HDD or SSD.

- [“Remove a Storage Array HDD or SSD \(CRU\)” on page 19](#)
- [“Install a Storage Array HDD or SSD \(CRU\)” on page 22](#)

## ▼ Remove a Storage Array HDD or SSD (CRU)

### 1. Enter the appropriate commands through the CLI to prepare the drive for removal from the storage array.

Use this procedure to logically remove a storage array drive from the system before you physically remove the drive.

The length of time that it takes to complete this procedure before you can physically remove the drive depends on the type of drive you are removing:

- **SSD** – The detach operation completes quickly and the drive can be removed immediately.
- **HDD** – The detach operation takes several minutes to complete. Do not remove the drive before the detach operation completes.

#### a. Log into the mcmu CLI as a primary admin such as mcinstall.

```
% ssh mcinstall@miniclusternode_name_or_IPaddress
```

where *miniclusternode\_name\_or\_IPaddress* is the name of the first node on MiniCluster, or the IP address of the first node.

For example:

```
% ssh mcinstall@mc4-n1
```

#### b. When prompted, enter the password.

For more information about running mcmu CLI commands, refer to the *Oracle MiniCluster S7-2 Installation Guide* or the *Oracle MiniCluster S7-2 Administration Guide*.

#### c. Identify the drive name.

You might be able to get the drive name from the error message or log file that led to the plan to replace the drive.

You can use a command such as `diskinfo`. Make note of the long drive name (such as `c0t5000CCA23B0BF34Cd0`) for use with this procedure. Also make note of the shorter name (such as `HDD8`) for use with the followup task when you reattach the replaced drive.

Also note that the storage array drives are identified by a JBODARRAY string.

For example:

```
% diskinfo
D:devchassis-path                c:occupant-compdev
-----
/dev/chassis/SYS/HDD0/disk        c0t5000CCA02D1EE2A8d0
/dev/chassis/SYS/HDD1/disk        c0t5000CCA02D1E7ACd0
```

```

/dev/chassis/SYS/HDD2/disk      c0t5000CCA02D1EDCECd0
/dev/chassis/SYS/HDD3/disk      c0t5000CCA02D1ED360d0
/dev/chassis/SYS/HDD4/disk      c0t5000CCA02D1EE6D8d0
/dev/chassis/SYS/HDD5/disk      c0t5000CCA02D1EE6CCd0
/dev/chassis/SYS/HDD6           -
/dev/chassis/SYS/HDD7           -
/dev/chassis/SYS/MB/EUSB-DISK/disk c1t0d0
/dev/chassis/JBODARRAY1/HDD0/disk c0t5000CCA25497267Cd0
/dev/chassis/JBODARRAY1/HDD1/disk c0t5000CCA2549732B8d0
/dev/chassis/JBODARRAY1/HDD2/disk c0t5000CCA254974F28d0
/dev/chassis/JBODARRAY1/HDD3/disk c0t5000CCA254965A78d0
/dev/chassis/JBODARRAY1/HDD4/disk c0t5000CCA254978510d0
/dev/chassis/JBODARRAY1/HDD5/disk c0t5000CCA254964E3Cd0
/dev/chassis/JBODARRAY1/HDD6/disk c0t5000CCA0536CA5E4d0
/dev/chassis/JBODARRAY1/HDD7/disk c0t5000CCA0536CA7B0d0
/dev/chassis/JBODARRAY1/HDD8/disk c0t5000CCA23B0BF34Cd0
/dev/chassis/JBODARRAY1/HDD9/disk c0t5000CCA0536CB828d0
/dev/chassis/JBODARRAY1/HDD10/disk c0t5000CCA0536CB308d0
/dev/chassis/JBODARRAY1/HDD11/disk c0t5000CCA0536CAF2Cd0
/dev/chassis/JBODARRAY1/HDD12/disk c0t5000CCA0536CABE4d0
/dev/chassis/JBODARRAY1/HDD13/disk c0t5000CCA0536CB684d0
/dev/chassis/JBODARRAY1/HDD14/disk c0t5000CCA0536CA870d0
/dev/chassis/JBODARRAY1/HDD15/disk c0t5000CCA0536CAB88d0
/dev/chassis/JBODARRAY1/HDD16/disk c0t5000CCA0536CA754d0
/dev/chassis/JBODARRAY1/HDD17/disk c0t5000CCA0536CAD10d0
/dev/chassis/JBODARRAY1/HDD18/disk c0t5000CCA0536CAEF8d0
/dev/chassis/JBODARRAY1/HDD19/disk c0t5000CCA0536CA83Cd0
/dev/chassis/JBODARRAY1/HDD20/disk c0t5000CCA04EB272E8d0
/dev/chassis/JBODARRAY1/HDD21/disk c0t5000CCA04EB27234d0
/dev/chassis/JBODARRAY1/HDD22/disk c0t5000CCA04EB27428d0
/dev/chassis/JBODARRAY1/HDD23/disk c0t5000CCA04EB272A0d0

```

**d. Use this syntax to detach the disk prior to removing the disk:**

```
% mcmu diskutil -D diskname
```

where *diskname* is the disk identifier of the drive you plan to remove.

For example:

```
% mcmu diskutil -D c0t5000CCA23B0BF34Cd0
```

```
.
```

```
<output omitted>
```

```
.
```

```
INFO:MCMU.controllers.common.pexpect_util:su to user oracle successfully.
```

```
[INFO ] logged into the zone f18-vm1-mc5qt-n1 as oracle
```

```
[INFO ] disk alias found to be RECO_0003
```

```
[INFO ] dropping disk c0t5000CCA23B0BF34Cd0s1
```

```

[INFO ] [' ', 'Diskgroup altered.', '']
[INFO ] ASM rebalance complete in diskgroup RECO in zonegroup f18
[INFO ] disk alias found to be DATA_0003
[INFO ] dropping disk c0t5000CCA23B0BF34Cd0s4
[INFO ] [' ', 'Diskgroup altered.', '']
[INFO ] ASM still initializing, please retry in a few minutes to check the
progress by running
'mcmu diskutil -p'

[INFO ] Disk should NOT be detached until rebalance is complete.

[INFO ] disk alias found to be SYSTEM_0003
[INFO ] dropping disk c0t5000CCA23B0BF34Cd0s5
[INFO ] [' ', 'Diskgroup altered.', '']
[INFO ] ASM rebalance in progress in the zonegroup f18.
Estimated time of completion is 61.

[INFO ] Disk should NOT be detached until rebalance is complete.
[INFO ] exiting surplus
[INFO ] Partitions to be dropped: [1]
[INFO ] Removing disk from zones...
[INFO ] Modifying zones: [u'f18-vm1-mc5qt-n1'] on node: mc5qt-n1
.
<output omitted>
.
[INFO ] Running.. exit
[INFO ] Disk {disk} being detached from Minicluster.

```

**e. Check the status of the detach operation.**

If you want to check the status, but the detach operation is still running, login to the mcmu CLI in another window.

Type:

```

% mcmu diskutil -p

[INFO ] Checking asm rebalance progress
.
<output omitted>
.
[INFO ] ASM Rebalance successfully complete. Attempting to remove disk from
zones.
.
<output omitted>
.
[INFO ] Disk successfully removed from Minicluster.

```

f. When the ASM rebalance is complete, you can remove the drive.

2. Locate the failed drive on the front of the chassis.



---

**Caution - Equipment damage.** Do not remove a drive unless you have an immediate replacement.

---

3. Remove the drive.

Press the button to release the drive lever [1], rotate the lever open and, grasping the drive body, slide the drive out of the chassis [2].

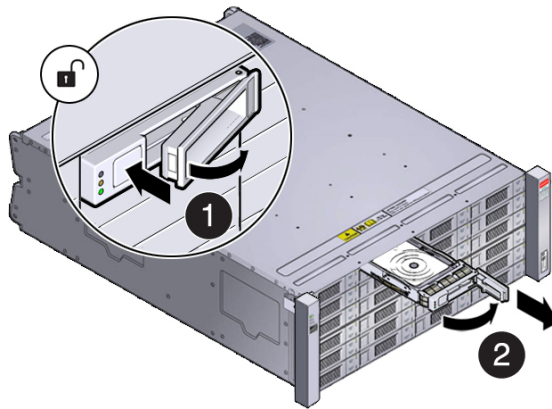

4. Install a replacement drive, if necessary.

See [“Install a Storage Array HDD or SSD \(CRU\)”](#) on page 22.

▼ **Install a Storage Array HDD or SSD (CRU)**

1. Install the replacement drive.

Open the drive lever on the replacement drive and slide the replacement drive as far into the drive slot as possible and then close the lever to lock it into place. Check that the drive is locked in place and flush with the other drives.

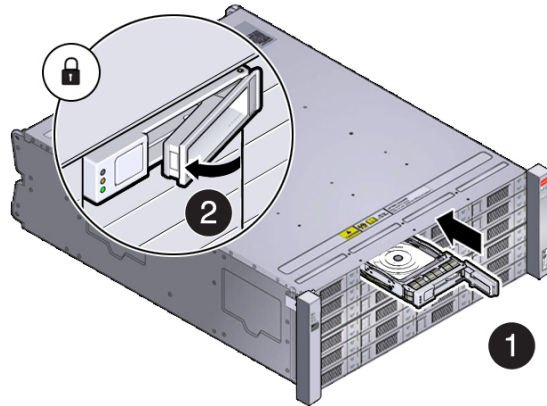

**2. Log into the mcmu CLI as a primary admin such as mcinstall.**

See [Step 1a](#) and [Step 1b](#) in “[Remove a Storage Array HDD or SSD \(CRU\)](#)” on page 19 for those instructions.

**3. Identify the full disk name of the replaced drive.**

You can use a command such as `diskinfo`.

In this example, HDD8 was replaced, and `diskinfo` shows that the full drive name for HDD8 is `c0t5000CCA0536CA710d0`.

Also note that the storage array drives are identified by a JBODARRAY string.

```
% diskinfo
D: devchassis-path                c: occupant-compdev
-----
/dev/chassis/SYS/HDD0/disk         c0t5000CCA02D1EE2A8d0
/dev/chassis/SYS/HDD1/disk         c0t5000CCA02D1E7AACd0
/dev/chassis/SYS/HDD2/disk         c0t5000CCA02D1EDCECd0
/dev/chassis/SYS/HDD3/disk         c0t5000CCA02D1ED360d0
/dev/chassis/SYS/HDD4/disk         c0t5000CCA02D1EE6D8d0
/dev/chassis/SYS/HDD5/disk         c0t5000CCA02D1EE6CCd0
/dev/chassis/SYS/HDD6              -
/dev/chassis/SYS/HDD7              -
/dev/chassis/SYS/MB/EUSB-DISK/disk c1t0d0
```

```
/dev/chassis/JBODARRAY1/HDD0/disk c0t5000CCA25497267Cd0
/dev/chassis/JBODARRAY1/HDD1/disk c0t5000CCA2549732B8d0
/dev/chassis/JBODARRAY1/HDD2/disk c0t5000CCA254974F28d0
/dev/chassis/JBODARRAY1/HDD3/disk c0t5000CCA254965A78d0
/dev/chassis/JBODARRAY1/HDD4/disk c0t5000CCA254978510d0
/dev/chassis/JBODARRAY1/HDD5/disk c0t5000CCA254964E3Cd0
/dev/chassis/JBODARRAY1/HDD6/disk c0t5000CCA0536CA5E4d0
/dev/chassis/JBODARRAY1/HDD7/disk c0t5000CCA0536CA7B0d0
/dev/chassis/JBODARRAY1/HDD8/disk c0t5000CCA0536CA710d0
/dev/chassis/JBODARRAY1/HDD9/disk c0t5000CCA0536CB828d0
/dev/chassis/JBODARRAY1/HDD10/disk c0t5000CCA0536CB308d0
/dev/chassis/JBODARRAY1/HDD11/disk c0t5000CCA0536CAF2Cd0
/dev/chassis/JBODARRAY1/HDD12/disk c0t5000CCA0536CABE4d0
/dev/chassis/JBODARRAY1/HDD13/disk c0t5000CCA0536CB684d0
/dev/chassis/JBODARRAY1/HDD14/disk c0t5000CCA0536CA870d0
/dev/chassis/JBODARRAY1/HDD15/disk c0t5000CCA0536CAB88d0
/dev/chassis/JBODARRAY1/HDD16/disk c0t5000CCA0536CA754d0
/dev/chassis/JBODARRAY1/HDD17/disk c0t5000CCA0536CAD10d0
/dev/chassis/JBODARRAY1/HDD18/disk c0t5000CCA0536CAEF8d0
/dev/chassis/JBODARRAY1/HDD19/disk c0t5000CCA0536CA83Cd0
/dev/chassis/JBODARRAY1/HDD20/disk c0t5000CCA04EB272E8d0
/dev/chassis/JBODARRAY1/HDD21/disk c0t5000CCA04EB27234d0
/dev/chassis/JBODARRAY1/HDD22/disk c0t5000CCA04EB27428d0
/dev/chassis/JBODARRAY1/HDD23/disk c0t5000CCA04EB272A0d0
```

#### 4. Use this syntax to attach a disk:

```
% mcmu diskutil -a diskname
```

where *diskname* is the name of the disk that you want to attach.

For example:

```
% mcmu diskutil -a c0t5000CCA0536CA710d0
```

## ▼ Replace a Storage Array Power Supply (CRU)

The storage array and the storage expansion shelf each have two power supplies. Indicators (LEDs) on the power supplies indicate their operation state.

The power supplies are redundant and one can be replaced while the appliance is running.



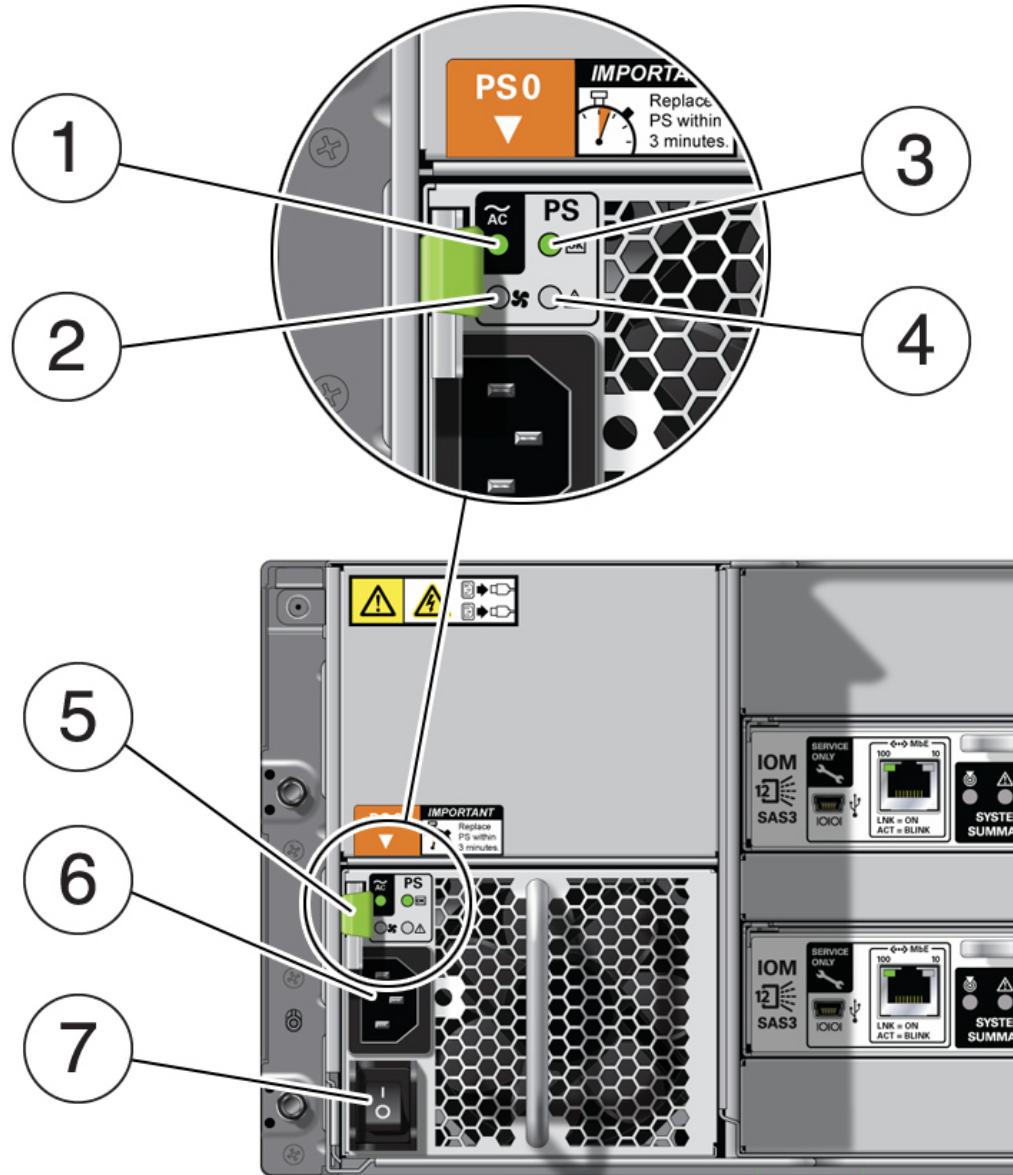

Callout	Description
1	AC power fail indicator
2	Fan fail indicator
3	Power supply status indicator
4	DC power fail indicator
5	Release lever
6	AC connector
7	On/Off switch

If any of the indicators are amber, or if the power supply status indicator does not light, replace the power supply.

- 1. Ensure the power supply on/off switch is in the "O" off position.**
- 2. Disconnect the power cord tie strap from the power cord, and unplug the power cord from the power supply.**
- 3. Remove the power supply unit.**

Grasp the power supply handle, push the release button [1], and slide the power supply out of the chassis [2].

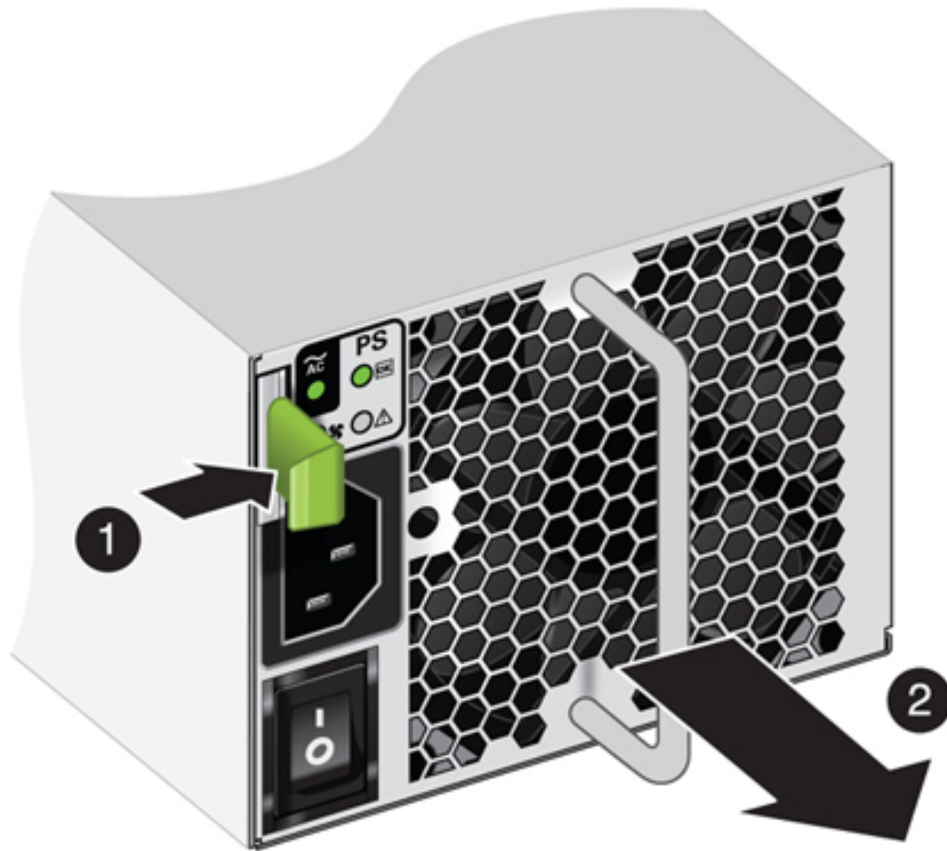

4. **Open the lever/ejection arms on the replacement power supply.**
5. **Slide the replacement power supply module into the chassis.**  
Be careful to not bend the pins.
6. **Close the lever/ejection arms.**  
Push the lever fully closed until you hear or feel a click.

## ▼ Replace a Storage Array I/O Module (CRU)

Storage array SAS I/O modules are fully redundant and can be replaced while the appliance is running.

### 1. Disconnect the cables from the I/O module.

Be sure to mark the cables so you can return them to their proper connectors.

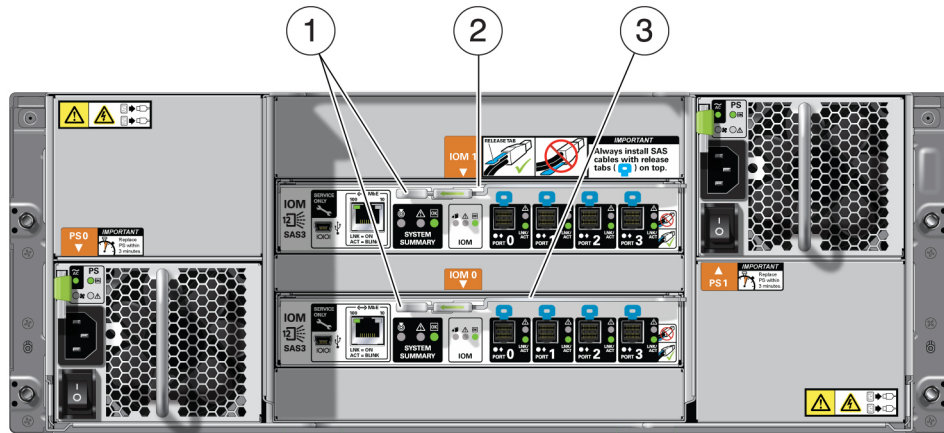

Callout	Description
1	I/O module locking levers
2	I/O module 1 (top)
3	I/O module 0 (bottom)

### 2. Remove the I/O module.

Using your thumb and forefinger, pinch the release buttons [1] together to release the locking lever [2]. Grasp the lever and remove the I/O module from the chassis [3].

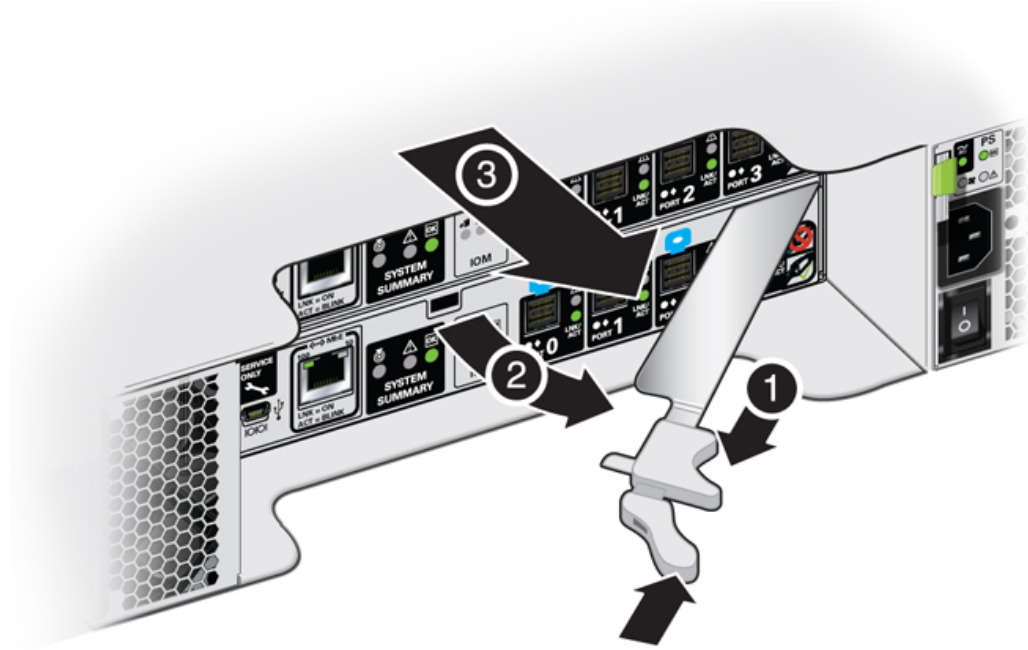

**Caution - Equipment damage.** Be careful not to damage the connector pins at the back of the I/O module.

3. **Open the lever in the new I/O module if it is not already open.**
4. **Slide the new I/O module into the disk shelf and close the locking lever.**
5. **Reconnect the cables.**
6. **Verify that the new I/O module is working correctly.**
  - After approximately 60 seconds, the power LED should be solid green and the Fault/Locate LED should be off.
  - For each port that has a cable connected, all four activity LEDs should be solid green.



# Servicing CRUs That Require Compute Node Power Off

---

These sections describe how to service customer-replaceable units (CRUs) for MiniCluster that require you to power off the compute node. All of these CRUs are located on the compute nodes.

---

**Note** - The servicing of hot-swap components such as the HDDs, SSDs, power supplies, and fans is described in [“Servicing CRUs That Do Not Require System Power Off” on page 17](#).

---

## Servicing Compute Node CRUs

This section describes how to service customer-replaceable units (CRUs) for the compute nodes that require you to power off the server.

---

**Note** - All of the CRUs on the storage array and the storage expansion shelf can be replaced while the power is on. See [“Storage Array Hot-Swappable Components” on page 18](#) for storage array component replacement procedures.

---

---

**Note** - The links in the following list take you to instructions *outside* of the MiniCluster library to the SPARC S7-2 documentation library. Use your browser's Back button to return to the MiniCluster library.

---

- [“Servicing DIMMs” in SPARC S7-2 Server Service Manual](#)
- [“Servicing the Battery” in SPARC S7-2 Server Service Manual](#)
- [“Servicing PCIe Cards” in SPARC S7-2 Server Service Manual](#)
- [“Servicing the Front Indicator Module” in SPARC S7-2 Server Service Manual](#)
- [“Servicing the eUSB Drive” in SPARC S7-2 Server Service Manual](#)





## Servicing FRUs

---

The following topics describe how to service field-replaceable units (FRUs) for MiniCluster. You must power down the system and disconnect the AC power cords from the server before servicing any of these components.

Only Oracle authorized service personnel should service FRU components.

## Servicing Compute Node FRUs

This section describes how to service compute node FRUs. Only Oracle authorized service personnel should service FRU components.

---

**Note** - Most of the links in the following table take you to instructions *outside* of the MiniCluster library to the SPARC S7-2 documentation library. Use your browser's Back button to return to the MiniCluster library.

---

- [“Servicing Cables” in \*SPARC S7-2 Server Service Manual\*](#)
- [“Servicing the Drive Backplane” in \*SPARC S7-2 Server Service Manual\*](#)
- [“Servicing the Motherboard” in \*SPARC S7-2 Server Service Manual\*](#)



## Returning MiniCluster to Operation

---

This chapter describes how to return MiniCluster to operation after you have performed service procedures. It includes:

- [“Returning the System to Operation” on page 35](#)
- [“Power On Procedure” on page 35](#)

### Returning the System to Operation

This section describes returning the system to operation after servicing.

---

**Note** - Some links in this table take you to instructions that are in other documents. Open the links in a new tab or use your browser's Back button to return to this document.

---

Task	For More Information
Replace the top cover.	<a href="#">Replace the Top Cover</a> in the <i>SPARC S7-2 Server Service Manual</i>
Return the server to the normal operating position.	<a href="#">Return the Server to the Normal Operating Position</a> in the <i>SPARC S7-2 Server Service Manual</i>
Reconnect cables.	<a href="#">Connecting Cables</a> in the <i>MiniCluster S7-2 Installation Guide</i>
Apply power to the storage array.	<a href="#">“Power On Procedure” on page 35</a> in this manual.
Apply power to the compute nodes.	<b>Note</b> - Do not power on the compute nodes until the disks on the storage array and storage expansion shelf have initialized.
Start the system.	<a href="#">Start the System</a> in the <i>MiniCluster S7-2 Administration Guide</i> .

### ▼ Power On Procedure

Perform the following procedure to power on the MiniCluster.

When powering on the system, each compute node is powered on separately.

1. **If you powered off and disconnected the power cords from a storage array (and storage expansion shelf if one is present), reconnect the power cords now.**
2. **Power on the storage array (and storage expansion shelf if one is present) by switching the power supply On/Off button on each power supply to the On position.**

The disks begin to initialize and the power supply LEDs light green. This can take several minutes.

---

**Note** - Do not power on the compute nodes until the disks on the storage array and storage expansion shelf have initialized.

---

3. **If you powered off a compute node, reconnect any unplugged power cords now.**
4. **Power on a compute node on using one of the following methods:**
  - Press the recessed Power button on the compute node front panel.
  - Log in to the Oracle ILOM web interface, click Host Management > Power Control, and select **Power On** from the Select Action list box.
  - Log in to the Oracle ILOM command-line interface (CLI), and type the following command at the Oracle ILOM CLI prompt.

-> **start /SYS**

When the server is powered on and the power-on self-test (POST) tests have completed, the green Power/OK status indicator on the compute node front panel lights and remains lit.

---

**Note** - If you powered off both compute nodes prior to servicing, repeat steps 3 and 4 to power on the second compute node.

---

5. **Refer to the *Oracle MiniCluster S7-2 Installation Guide* and *Oracle MiniCluster S7-2 Administration Guide* for any instructions or commands required to return the appliance to service.**

# Index

---

## C

- compute node
  - cold-swappable components, 31
  - hot-swappable components, 17
  - servicing
    - battery, 31
    - cables, 33
    - DIMMs, 31
    - drive backplane, 33
    - drives, 17
    - eUSB drive, 31
    - fan modules, 17
    - front indicator module, 31
    - motherboard, 33
    - PCIe cards, 31
    - power supplies, 17
  - status indicators, 9
- CRUs
  - not requiring system power off (hot-swap), 17
  - requiring system power off (cold-swap), 31

## F

- faults, detecting and managing, 14
- FRUs, servicing, 33

## P

- powering on system, 35
- preparing system for service, 13

## R

- returning system to operation, 35

## S

- service categories, 13
- status indicators
  - compute node, 9
  - storage array
    - back panel, 11
    - front panel, 9
- storage array
  - hot-swappable components, 18
  - servicing
    - drives, 18
    - I/O module, 28
    - power supplies, 24
  - status indicators
    - back panel, 11
    - front panel, 9

